

# Plat Map

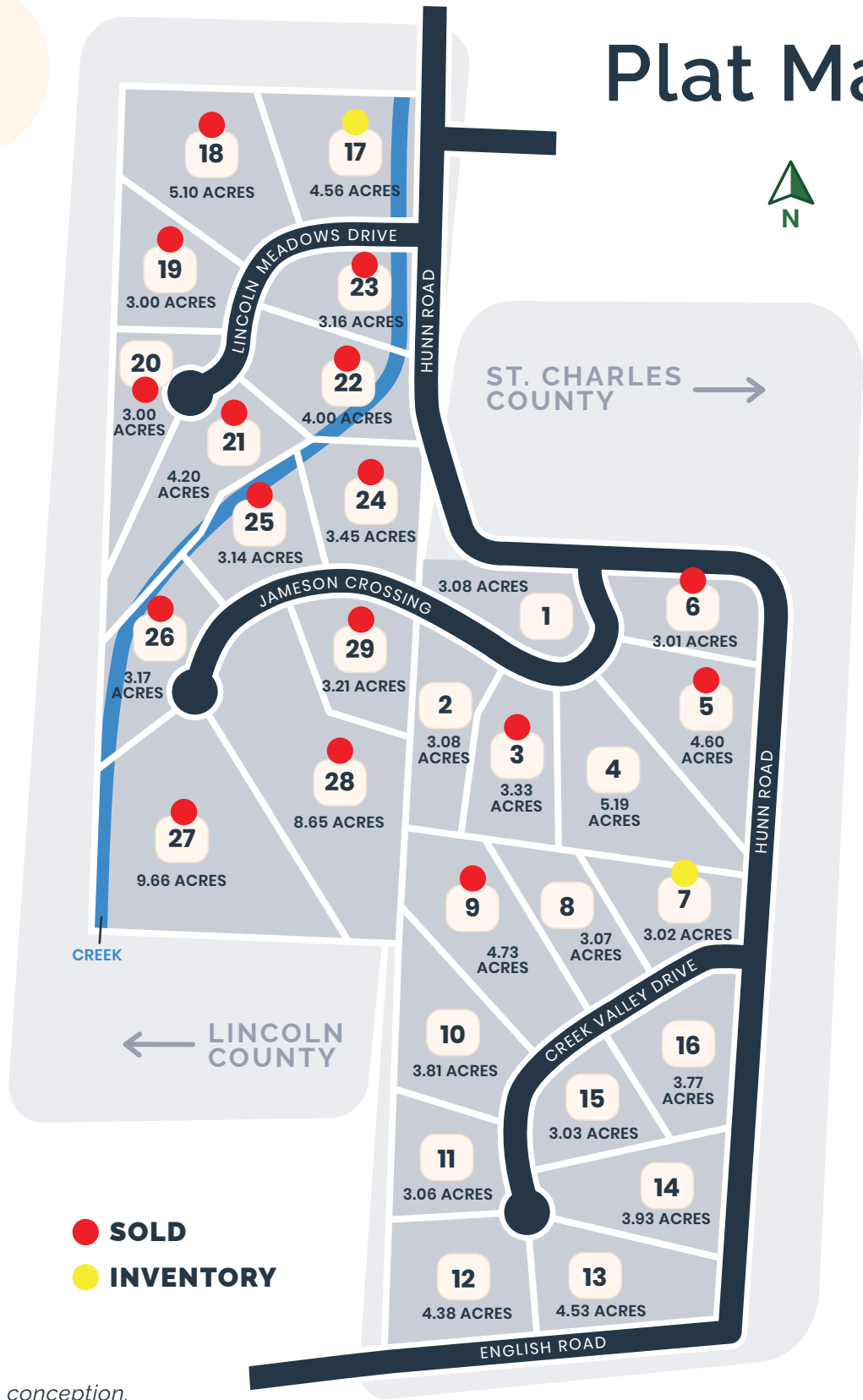

*This Plat Map is an artist's conception.  
 Selected homesites carry a premium.  
 Please see Sales Manager for more information.*



# Lot Matrix

| LOT # | ADDRESS                   | ACREAGE | PRICE            |
|-------|---------------------------|---------|------------------|
| 1     | 101 Jameson Crossing      | 3.08    | \$145,000        |
| 2     | 116 Jameson Crossing      | 3.08    | \$145,000        |
| 3     | 112 Jameson Crossing      | 3.33    | <b>SOLD</b>      |
| 4     | 108 Jameson Crossing      | 5.19    | \$165,000        |
| 5     | 104 Jameson Crossing      | 4.6     | <b>SOLD</b>      |
| 6     | 100 Jameson Crossing      | 3.01    | <b>SOLD</b>      |
| 7     | 201 Creek Valley Drive    | 3.02    | <b>Inventory</b> |
| 8     | 205 Creek Valley Drive    | 3.07    | \$160,000        |
| 9     | 209 Creek Valley Drive    | 4.73    | <b>SOLD</b>      |
| 10    | 213 Creek Valley Drive    | 3.81    | \$160,000        |
| 11    | 217 Creek Valley Drive    | 3.06    | \$160,000        |
| 12    | 221 Creek Valley Drive    | 4.38    | \$170,000        |
| 13    | 220 Creek Valley Drive    | 4.53    | \$170,000        |
| 14    | 216 Creek Valley Drive    | 3.93    | \$165,000        |
| 15    | 212 Creek Valley Drive    | 3.03    | \$155,000        |
| 16    | 200 Creek Valley Drive    | 3.77    | \$165,000        |
| 17    | 301 Lincoln Meadows Drive | 4.56    | <b>Inventory</b> |
| 18    | 305 Lincoln Meadows Drive | 5.1     | <b>SOLD</b>      |
| 19    | 309 Lincoln Meadows Drive | 3.06    | <b>SOLD</b>      |
| 20    | 313 Lincoln Meadows Drive | 3.02    | <b>SOLD</b>      |
| 21    | 312 Lincoln Meadows Drive | 4.27    | <b>SOLD</b>      |
| 22    | 308 Lincoln Meadows Drive | 4.03    | <b>SOLD</b>      |
| 23    | 300 Lincoln Meadows Drive | 3.16    | <b>SOLD</b>      |
| 24    | 121 Jameson Crossing      | 3.45    | <b>SOLD</b>      |
| 25    | 125 Jameson Crossing      | 3.14    | <b>SOLD</b>      |
| 26    | 129 Jameson Crossing      | 3.17    | <b>SOLD</b>      |
| 27    | 128 Jameson Crossing      | 9.66    | <b>SOLD</b>      |
| 28    | 124 Jameson Crossing      | 8.65    | <b>SOLD</b>      |
| 29    | 120 Jameson Crossing      | 3.21    | <b>SOLD</b>      |

\*